

SOLAWAVE

INSTRUCTION MANUAL

WRINKLE RETREAT LIGHT THERAPY FACE MASK

SOLAWAVE

COMPANY INFORMATION

We're not here to discuss flaws. In fact, we don't believe in them. Lines, spots, bumps, and texture get bad press, but they're just different terrains you might encounter on your unique, ongoing skincare journey. After years of working in the skincare and beauty industries, we're flipping the script on who has access to the best tools and technologies to support that journey.

At Solawave, we believe everyone has the right to high-quality skincare. The best tools for any journey are simple, easy to use anywhere, and designed for everyone. Our mission is to put the power of Solawave in the hands of all people. We're taking restorative rituals and acts of renewal out of the doctor's office and putting them within your reach to support your skin journey, wherever you are.

LIGHT THERAPY

With consistent use, the Solawave Wrinkle Retreat Facet Mask can increase collagen production and the body's natural rejuvenation processes, resulting in youthful skin and overall improvement in your skin's texture and complexion.

The light does not emit harmful UVA or UVB rays and is not a laser. This means that users require zero recovery or down time after treatment. Solawave's LED light therapy is for skin rejuvenation and will not darken or tan the skin.

- Clinically proven
- Non-invasive
- 10-minute treatment session
- Skin boosting
- Restores collagen
- Plumps and smooths fine lines
- Prevents wrinkles
- Soothes redness and inflammation
- Evens out skin tone
- Clears up skin imperfections
- Hydrates skin for a more youthful glow

GENERAL DEVICE INFORMATION

The Solawave Wrinkle Retreat Face Mask is an FDA-cleared light therapy medical device that is intended to treat wrinkles and fine lines.

DESCRIPTION OF THE DEVICE

The Solawave Wrinkle Retreat Face Mask is a revolutionary device that offers two light therapy wavelengths in one device:

1. Red Light Therapy
2. Near-Infrared Light Therapy

DEVICE SPECIFICATIONS

LED wavelengths	630nm, 830nm
Max. output optical power density	30 mW/cm ²
LEDs	66 Dual-core LEDs
Operating temperature	0°C–40°C 32°F–104°F
Storing and transport temperature	-5°C–55°C 23°F–131°F
Operating humidity	30%–95% without condensation
Storage and transport humidity	20%–95% without condensation
Operating/Storage Environment Atmospheric Pressure	700hPa–1060hPa (e.g., sea level height)

Charging supply	5V 1A
Charging port	USB C
Charging cable	USB-C to USB-A
Charging cable length	1 meter/3.28 feet
Battery	3.7V, 2600 mAh
Battery type	Lithium-ion
Charging time	150 minutes / 2.5 hours
Recommended use	Once per day, 3-7 times per week
Treatment time	10 minutes
Materials	Silicone, Plastic (PC), Nylon
Dimensions of the device	288 x 189 x 18 mm
Weight of the device	256g

DEVICE ACCESSORIES

1. Wrinkle Retreat Face Mask
2. Handheld Controller & Rechargeable Battery
3. Detachable Protective Eyewear
4. Adjustable, Detachable Head Strap, and Optional Second Head Strap for added comfort
5. USB-C to USB-A Charging Cable
6. Storage Bag

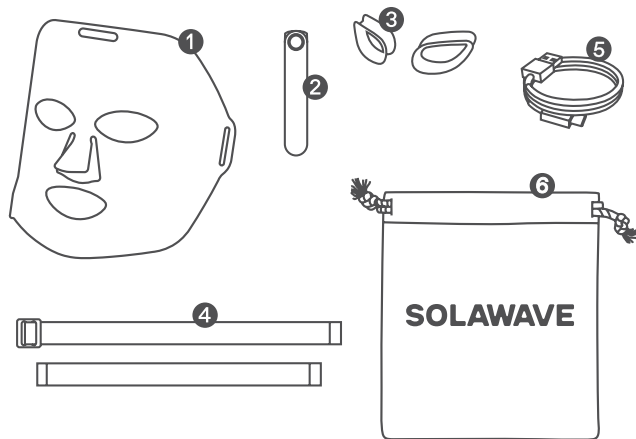

HOW TO ATTACH THE STRAPS

1. Lay the mask with the logo side facing you. Take the Head Strap (#4) and push the plastic buckle through the left-side opening of the mask. Ensure the Solawave logo on the rubber lip is facing up.
2. Thread the other end of the head strap (velcro side) through both openings of the plastic buckle. Continue to pull the strap through the buckle until around 6 inches of the strap is pulled through.
3. Flip the mask over (LED side facing you) and pull the rubber velcro side through the left-side opening of the mask and secure the velcro.
4. Adjust the head strap by sliding the buckle to ensure a tight fit on your head.

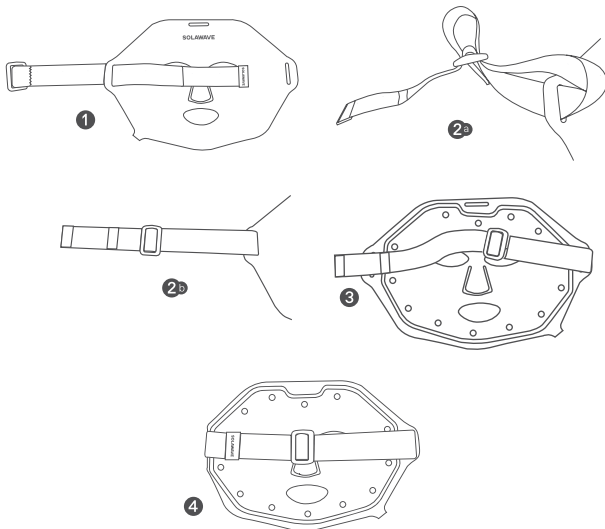

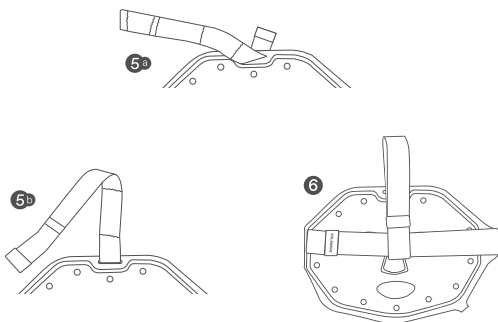

Optional:

1. For a more secure fit, you can attach the Second Head Strap (#5). Look for the end that has a longer strip of velcro on it. Attach that end to the top opening of the mask.
2. Attach the other end over the main head strap.

We know written instructions can be confusing and so we've recorded a video to walk you through setting up the mask.

Scan the QR code to watch a quick tutorial on how to set up your mask.



ADVERSE REACTION

If you have any adverse reaction from using this device, such as discomfort, skin discoloration, skin irritation, or other concerns, stop using it immediately and consult your health professional. Skin irritation, bruising, contact burns, dizziness, nausea, and headaches are rare but possible side effects. Immediately stop using the device and contact your health professional.

If you experience a persistent headache and/or other persistent painful sensations while using this device, stop using it and consult with your health professional.

CONTRAINDICATIONS

- **DO NOT** use the device if you are/on people under the age of 22.
- **DO NOT** use the device if you are pregnant, planning to conceive, or breastfeeding.
- **DO NOT** use the device if you suffer from any skin condition other than mild to moderate acne.
- **DO NOT** use the device if you have severe acne.
- **DO NOT** use the device if you have Fitzpatrick Skin Type V or Type VI.
- **DO NOT** use the device over areas with phlebitis, thrombophlebitis, and varicose veins.
- **DO NOT** use the device if you have active cancer or any cancerous lesion.
- **DO NOT** use the device if you suffer from light-induced headaches.
- **DO NOT** use the device if you suffer from any photosensitive disorder (light sensitization).
- **DO NOT** use the device if you have a medical history of seizures triggered by light.
- **DO NOT** use the device if you have a history of epilepsy.
- **DO NOT** use the device if you are taking any medication or drugs that can cause photosensitivity. If you are unsure about your medication, consult your healthcare provider.
- **DO NOT** continuously press the ON/OFF button.

Note: For hygienic reasons, we do not recommend sharing your device with other people.

Note: We highly suggest caution when taking any (skin related) damaging medications. If indoubt, consult your healthcare provider.

Note: If you are under the care of a physician, consult your physician before using this device.

WARNINGS

- **STOP** using the device and consult your healthcare provider if you experience any adverse reaction from using the device.
- **STOP** using the device if you experience any discomfort or difficulty breathing or swallowing from application of the device on the neck.
- **STOP** using the device if you experience symptoms of hypotension (dizziness or light-headedness) while using the device.
- **STOP** your treatment if it feels hot or your skin feels uncomfortably warm.
- **STOP** using the device if it is overheating. Turn off the device immediately.
- **DO NOT** stare directly at the LEDs when the device is turned on. This may cause temporary loss of sight.
- **DO NOT** shine the light from the LEDs directly into your eyes or someone else's eyes. This may cause temporary loss of sight.
- **DO NOT** use the device on painful areas. Consult your healthcare provider if you experience any pain during use.
- **DO NOT** use the device to treat rosacea, moles, warts, open sores, cancerous lesions, or any skin condition.
- **DO NOT** use the device over a bacterial infection as this may result in the worsening of symptoms.
- **DO NOT** use the device on swollen, infected, or inflamed areas, or skin eruptions
- **DO NOT** place the device directly over an open wound.
- **DO NOT** use the device on areas without pigmentation or areas of skin that have vitiligo.
- **DO NOT** use the device with any topical other than specified by Solawave.
- **DO NOT** use the device on or near children or those with reduced physical and mental abilities. Close supervision is necessary when this device is used, cleaned, or stored near children or those with reduced physical or mental abilities.
- **DO NOT** let children or those with reduced physical and mental abilities use the device.
- **DO NOT** let children play with the device. Cleaning and charging the device shall not be done by children.
- **DO NOT** bend, twist, or pull the device.
- **DO NOT** sit, lay down, or step on the device as this will result in breakage.

- **DO NOT** drop or insert any object into any openings of the device.
- **DO NOT** use or store the device near hot surfaces.
- **DO NOT** store the device in extreme heat or cold.
- **DO NOT** use the device outdoors to prevent damage to the product.
- **DO NOT** place the device in direct sunlight.
- **DO NOT** charge the device where it is close to or might get in contact with water.
- **DO NOT** submerge the device in water.
- **DO NOT** use the device if it is not working properly or if it has been dropped or damaged. For warranty and repairs, contact customer support.
- **DO NOT** perform maintenance or take apart the product. In case of malfunction or damage, contact customer support.
- **DO NOT** attempt to modify the device in any way. Modifying or opening the device will void your warranty. The device contains no serviceable parts. This device contains batteries that are non-replaceable.
- **DO NOT** use the device if the charging cable is damaged.
- **DO NOT** use the device with any other USB-C cable than that provided by Solawave.
- **DO NOT** use the device with non-manufacturer approved accessories.
- **DO NOT** use solvents or abrasive cleaners on the device unless explicitly specified in this manual or by customer service.
- **DO NOT** use the device in any other way than specified in this manual.
- **DO NOT** use the device if you have recently had surgery or other surgical procedures.
- **DO NOT** use the device without the Protective Eyewear properly installed. If you have lost the Eyewear or are unsure on how to install them, please reach out to Solawave support.

PRECAUTIONS

- Do not scratch or damage the light-emitting surface.
- Not operating the device in accordance with the instructions in the manual will void your warranty.
- Read all instructions carefully before using this device.
- Store the device according to the protocol outlined in this manual.
- This device is intended to be used by one person only.
- The device is designed for cosmetic use only, for individuals with good health. Please contact your health professional if you are unsure about your health status.

- The device's battery is not removable. If you are disposing of the device, do not burn it or throw it in the trash. Dispose of the device according to local regulations.
- Inspect the device and do not use it if you see any signs of damage, such as internal battery leaks. If anything seems out of the ordinary, contact our customer support.
- The device should only be supplied with 5V DC low voltage. If any part of the main adapter or cord is damaged, discontinue use. Contact customer support to arrange a replacement.
- Consult your health professional before using the device if you have a fever, acute inflammation, a severe circulatory disorder, light sensitivity, anesthetic, or desensitized areas.
- We highly suggest using caution if you are taking any medications. If in doubt, consult your health professional.
- Some users may experience skin irritation or hypersensitivity due to the electrical stimulation or the topical product applied. If using the device causes persistent pain or discomfort, discontinue use immediately.
- There may be a perception of flashing lights during the use of the device, resulting from the stimulation of your optic nerve. If you notice this condition constantly without the use of your device, consult your health professional.

TRAVEL AND INTERNATIONAL USE

The device's lightweight design makes it a perfect travel companion. Here are some travel tips:

- If you are traveling to a different region to where you bought the device, please ensure that the device is only supplied with a 5V DC low voltage.
- Prior to your flight, confirm with a steward that the device can be carried and/or used on the airplane.

DISCLAIMER

This device is not intended to diagnose, cure, or prevent disease. Solawave makes no claims, representations, or warranties regarding the ability of this device to cure any physical, skin, or mental condition. A qualified health professional should be consulted regarding any condition requiring medical attention.

RISKS AND BENEFITS

POTENTIAL RISKS

- Immediately after treatment, skin may appear red. Skin should return to normal within 1–2 hours.
- Temporary headaches may develop immediately following the light treatment. Headaches can be treated with an appropriate pain killer and rehydration.

POTENTIAL BENEFITS

- Red Light Therapy: reduces the appearance of fine lines and full-face wrinkles and deeply rejuvenates the skin.
- Near-Infrared Light Therapy: helps manage suboptimal local blood flow and circulation while addressing muscle and joint pain.

LIGHT SENSITIVITY TEST

We highly recommend users perform a light sensitivity test before their first use of the device.

1. Place the device on the inner forearm.
2. Turn on the device to start a treatment.
3. Wait until the treatment is done. The full treatment will take 10 minutes to complete.
4. **If your skin feels hot or uncomfortable during the treatment, stop immediately!** You might be sensitive to light.
5. The device will automatically turn off after the treatment is done. Remove the device and wait for at least 24 hours before your next treatment.

Check your skin regularly over those 24 hours. If your skin appears red and/or itchy, the device is unsuitable for you. In case of sensitivity to the light, please contact customer support.

HOW TO USE THE DEVICE

GENERAL USE

1. Prior to using the device, make sure the controller is fully charged and that the Protective

Eyewear is inserted in the mask. The Protective Eyewear is required in order to use the device- please ensure they are properly installed each time you use the device.

2. Clean your face with a cleanser.

3. Make sure the controller is unplugged from the charger and place the device on your face.

4. Turn on the device by pressing the ON/OFF button on the controller for 1-2 seconds. The lights on the controller will turn on when the button is pushed for 1 full second, indicating that the device is turned on. Note: Device should only be turned on when secured on your face.

a. The device's default treatment is anti-aging. The word "Anti-Aging" will light up on the controller.

b. To switch to the anti-acne treatment, press the ON/OFF button shortly (less than one second). The word Anti-Acne will light up.

5. Enjoy the treatment.

a. The device switches off automatically after a 10-minute treatment session.

b. You may stop the treatment at any time by pressing the ON/OFF button for more than one second.

6. Remove the device from the treatment area.

7. You may clean the device using a water-based wipe or a 70% alcohol wipe. Ensure the device is not connected to the power supply when cleaning. Do not submerge the device in water or apply water directly to the device.

8. Repeat these steps based upon the treatment protocol described next. in water or apply water directly to the device.

TREATMENT PROTOCOL

Use the device 10 minutes per day, 3 days per week for a minimum of 4 weeks. After that, you can continue using the device as desired, based on your lifestyle and skin condition.

We do not recommend using the device more than once a day.

Always be mindful of how your skin reacts to beauty devices, and decrease usage if redness or irritation occur.

CHARGING

Charge your device fully for 4 hours prior to your first use. Only use a 5V adapter or USB port (most computers have one). Avoid fast chargers as they can damage the battery. To charge the device, connect the charger to the device. Insert the USB-A side of the cable into a USB power supply. The LED indicator on the device will start to blink to indicate charging. When the device is fully charged, the LED indicator will stay on.

If the LED indicator remains on when you first connect the charging cable, then your device is already fully charged and you may begin using. If the light is blinking please charge until the light remains steady.

Before charging, make sure that the plug and socket are completely dry. Failure to do so may result in electric shock, short circuit, or fire.

Note: Always unplug the device before use. The device will not work while being charged.

TROUBLESHOOTING

If the following suggestions do not fix the problem or the problem reoccurs, and your device is within the warranty period, please return it to Solawave.

- **DO NOT** attempt to investigate any further.
- **DO NOT** attempt to modify the device in any way. The device has NO parts you can repair yourself.

Problem	Cause	Solution
The device doesn't switch on.	The device is not fully charged, because the charging cable was not properly inserted into the power outlet.	Insert the charging cable properly into the power outlet.
	The power outlet didn't work during charging.	Try a different power outlet.
	The device is not fully charged, because the cable was not properly connected to the device.	Connect the cable properly to the device and charge the device.
	The ON/OFF button has not been pushed for 2 full seconds.	Push the ON/OFF button for 2 full seconds.
The device switches off unexpectedly.	The battery level is too low.	Charge the device.
The controller turns on, but the mask does not	Cable between controller and mask is not properly inserted.	Insert the USB-A cable into the controller.
The controller does not charge	The power outlet doesn't work.	Try using a different power outlet.
	The charger used is not compatible with the device. (Examples: fast chargers, USB PD chargers)	Use a 5V 1A USB-A charger

CARE AND STORAGE

The lifetime of the lithium battery can be maximized by allowing it to fully charge and discharge during regular use. Allow the device to deplete before charging again. Do not charge after every session.

- Store the device at room temperature in dry conditions.
- Store the device in the supplied bag. Make sure the device will not bend, stretch, or be crushed while being stored or when traveling.
- Avoid storing the device in dusty conditions, direct sunlight, or damp and humid conditions.
- This device contains no serviceable parts.
- Before each use, ensure the device is switched off and clean it, following the cleaning instructions below.

IMPORTANT

- The product has a limited lifecycle of two years under nominal use. Following the treatment protocol for two years is considered nominal use.
- The device must be handled with care.

CLEANING

- Clean the Device with a water-based wipe or damp clean cloth. Stubborn stains can be removed by wiping gently with 70% alcohol. Ensure the device is turned off and not connected to the charger when cleaning.
- **DO NOT** use any other cleansing devices as these may damage the device.
- **DO NOT** clean the device while it is turned on.
- **DO NOT** clean the device while it is charging.

DISPOSAL

- **DO NOT** dispose of the device with household waste. The device should be recycled. The device contains a lithium-ion battery. For protection of the environment, please safely dispose of the device following your local guidelines.

WARRANTY

Limited Warranty

Solawave warrants that this product is free of defects in materials and workmanship for one (1) year from the date of purchase. This warranty is valid only in accordance with the conditions set forth below:

- Normal wear and tear is not covered by this warranty.
- This one (1) year warranty applies to consumer use only and is void when the product is used in a commercial or institutional setting.
- This warranty extends only to the original purchaser and is not transferable. In addition, proof of purchase must be demonstrated. This warranty is void if the product has been subject to accident, misuse, abuse, improper maintenance or repair, unauthorized modification, or any other use not found in the printed instructions.

This limited warranty is the only written or expressed warranty given by Solawave. Any implied warranties on the product (including but not limited to any implied warranties of merchantability or fitness for a particular purpose) are limited in duration to the duration of this warranty. Some statutes do not allow limitations on how long an implied warranty lasts, so the above limitation may not apply to you.

Repair or replacement of the product is the exclusive remedy of the consumer under this warranty. Solawave shall not be liable for any incidental or consequential damages for breach of this warranty or any implied warranty on this product. Some states do not allow the exclusion or limitation of incidental or consequential damages, so the above limitation or exclusion may not apply to you.

Procedure for Warranty Repairs or Replacement:

If warranty service is necessary, the original purchaser must contact Solawave for warranty service instructions at support@mysolawave.com

For your protection, it is suggested you insure the shipment of the device back to Solawave. Damage that occurs during shipment is not covered. Packages that are missing proper documentation and accessories may not be processed.

SAFETY









The device complies with Part 15 of the FCC Rules. Operation is subject to the following two conditions: (1) this device may not cause harmful interference, and (2) this device must accept any interference received, including interference that may cause undesired operation.







The device has been tested to or complies with the following standards:

- EN 60601-1:2006/A12:2014, Medical electrical equipment. General requirements for basic safety and essential performance.
- EN 60601-1-2:2015 Medical electrical equipment. General requirements for basic safety and essential performance. Collateral standard: Electromagnetic compatibility requirements and tests.
- IEC 60601-1-6 2010 AMD12013 Medical Electrical Equipment—Part 1: General Requirements for Basic Safety and Essential Performance. Collateral standard: Usability.
- IEC/EN60601-1-11:2015 Medical electrical equipment—Parts 1–11: General requirements for basic safety and essential performance. Collateral standard: Requirements for medical electrical equipment and medical electrical systems used in the home healthcare environment.
- IEC/EN 60601-2-57:2011 Medical electrical equipment. Particular requirements for the basic safety and essential performance of non-laser light source equipment intended for therapeutic, diagnostic, monitoring, and cosmetic/aesthetic use.
- EN 62471:2008 Photobiological safety of lamps and lamp systems.
- EN 62366-1:2015 Application of usability engineering to medical devices.
- EN ISO 10993-1:2010-04 Biological evaluation of medical devices—Part 1: Evaluation and testing.
- EN ISO 15223-1:2017 Medical Devices—Symbols to be used with medical device labels, labeling and information to be supplied—Part 1: General requirements.
- EN ISO 14971:2012 Medical devices—Application of risk management to medical devices.
- EC62133:2012 2nd ed. Secondary cells and batteries containing alkaline or other non-acid electrolytes—Safety requirements for portable sealed secondary cells, and for batteries made from them, for use in portable application.
- Restriction of Hazardous Substances (RoHS) Directive (2011/65/EU).
- Registration, Evaluation, Authorization and Restriction of Chemicals (REACH) directive (EC 1907/2006).

SYMBOLS

Symbol	Explanation
	Indicates the device is CE Marked and authorized to sell in Europe. (Lower-Voltage-Directive)
	The Waste of Electrical and Electronic Equipment (WEEE). Indicates the device may not be discarded as household waste (2012/19/EU).
	Indicates that the electromagnetic radiation from the device is below the limits specified by the Federal Communications Commission, and the manufacturer has followed the requirements of the Supplier's Declaration of Conformity authorization procedures.
	Restriction of Hazardous Subs.
	Warning to read the enclosed documents before use and to take all safety precautions required.
	Read the user manual before you start using the device.
	"Manufactured by". Provides the name and address of the legal manufacturer.
	Made in China.

Symbol	Explanation
	Date of manufacture.
	Type BF Applied Part. B indicates it is used for the body, and F indicates that it is not connected to the mains voltage.
	Keep the device dry.
	Serial number.
	Batch code of the device.
	USB connector.
	This device uses a Lithium-ion Polymer battery.
	Keep away from direct sunlight.
	Upper and lower operating temperatures that the device can be safely used at.

Symbol	Explanation
	Class II Medical Electrical Device.
	Unique Device Identifier.
	Expiry date.
	This symbol implies conformity to UK Directives on health, safety and environmental protection standards. UKCA stands for UK Conformity Assessed.
	Upper and lower operating humidity that the device can be safely used at.
	The cardboard packaging that the device came in can be recycled.
IP22	The device is protected against a solid object greater than 12.5mm such as a finger and against vertically falling drops of water at up to 15 degrees from vertical.
	Handle the packaging with care.

FAQS

For more information, visit the FAQs section in our website:

<https://www.solawave.co/pages/faqs>

CONTACT INFORMATION

Solawave Inc.

3641 Holdrege Avenue

Los Angeles, CA 90016

www.mysolawave.com

@solawave

Date of issuance:
January 2024

V 1.0

MK-13B 说明书

成品尺寸:100*146 MM

材质:封面封底128克双铜, 过哑膜, 4C+1专

内页80克书纸, 黑白印刷

装订:骑马钉



PANTONE 4975C